

Aluminum Steering Block Installation Instructions

Covers Part #5536R



Tools Needed

- 1.5mm hex wrench
- 2.0mm hex wrench
- 2.5mm hex wrench
- 7.0mm nut driver
- Needle-nose pliers

Remove the front wheels

- Remove the two 4.0mm nylon locknuts from the front wheel spindles with a 7.0mm nut driver. Remove the wheels from the spindles. (A)



Disconnect the steering linkage

- Disconnect the toe links (tie rods) from the steering blocks by removing the two 3x15mm button-head machine screws. (B & C)

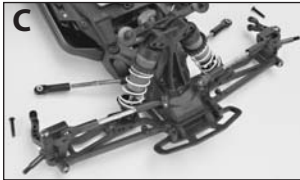
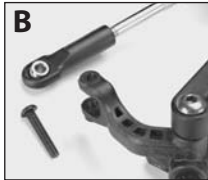

Remove the steering blocks

- Remove the 4x4mm button-head machine screws from the top of each caster block. (D)
- Loosen the 3x3mm set screw located in the back of each wheel spindle. Push the 35mm suspension pins up and out of the caster blocks from the bottom by using a small hex wrench. (E & F)



- Separate the steering block from the caster block and pull the wheel spindle out of the steering block. (G)



Install the aluminum steering blocks

- Insert the wheel spindles into the aluminum steering block in the same orientation as they were installed in the stock steering blocks. Align the hole in the wheel spindle with the suspension pin hole in the steering block. (H & I)

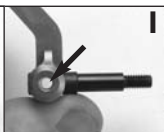
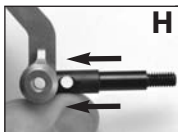

- Insert the right steering block (marked with an "R") into the right-hand caster block. Insert the left steering block (marked with an "L") into the left-hand steering block. The stamped letters should face down (see J & K for correct orientation).



- Insert the 35mm suspension pins into the hole at the top of each caster block (L) and secure each with a blue 4x4mm button-head machine screw (M). Also, tighten the 3x3mm set screw located in the back of each wheel spindle to secure the 35mm suspension pins. (N)



Attach steering linkage

- Remove the stock hollow ball located in the end of each toe link with a pair of needle-nosed pliers. Replace them with the included single-shear hollow balls. **Note:** the flange on the hollow ball must face up. (O)
- Attach the toe links (tie rods) to the steering blocks using the included button-head machine screws (coated with thread-locking compound). The 3x15mm button-head machine screws (w/spacers) are for use with the 30-degree caster blocks. The two 3x12mm button-head machine screws are for use with the 25-degree caster blocks.

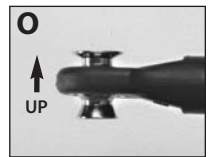

- 30-degree caster blocks - 3x15mm button-head machine screw, use one spacer (included) beneath each hollow ball. (P)
- 25-degree caster blocks - 3x12 button-head machine screw, no spacer. (Q)

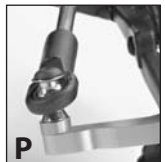

Reattach wheels

- Install the front wheels back onto the spindle, and secure them with 4.0mm nylon locknuts.

Tip: Always use thread-locking compound on fasteners that thread into aluminum parts to prevent the fasteners from loosening.

If you have questions or need technical assistance, call Traxxas at
1-888-TRAXXAS

(1-888-872-9927) (U.S. residents only)